

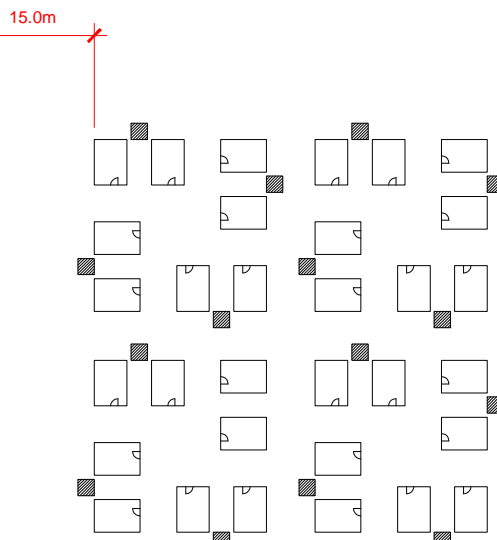





COMMUNITY LAYOUT 1



COMMUNITY LAYOUT 2

-  Water distribution point
-  Existing tree
-  Household latrine
-  Communal latrine block
-  Existing permanent structure

NOTES

- Proposed camp population: 5'856 persons
- Shelters: 976 units
- Shelter dimensions: 5.6m x 4m
- Water distribution points: 9 units x 6 taps
- Communal Latrines: 4 blocks x 40 drop holes
- Household latrines: 488 units